

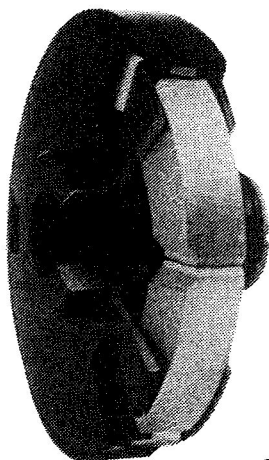

358 NW F Street Richmond, IN 47374-2297  
 (765) 966-8161 Fax: (765) 935-2346  
 1-800-999-8161 http://www.hoffcocomet.com

# AUTOMATIC CENTRIFUGAL CLUTCHES



**CSC**  
**400**  
**SERIES**

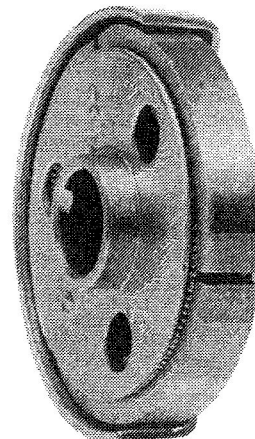

**SCS**  
**400**  
**SERIES**

**CSC**  
**400**  
**SERIES**

## SINGLE SPROCKET SELF CONTAINED

Popularity of these four models allows greater production economics without sacrifice of quality . . . and we pass these savings on to you. The 400 Series clutches have more contact surface than most competitors. The 400 Series clutch has built-in staying power. Almost 3-3/4 square inches of steel friction material engagement shoe surface assures positive pulling power as long as the R.P.M. is in full contact range. There's no slipping when you need the "go-power". The 400 Series clutches have continued performance even when they were partly destroyed in torture tests. Bearings have been almost completely worn through by sand and the 400 Series continued to function.

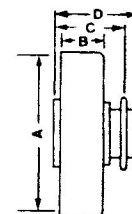

ORDER NO.	TYPE	TEETH	BORE	PITCH	A	B	C	D
209748A	CSC*	11	5/8	35	4"	1"	1.74	2.22
211627A	CSC*	12	5/8	35	4"	1"	1.74	2.22
209760A	CSC*	12	3/4	35	4"	1"	1.74	2.22
209768A	CSC*	10	3/4	40/41	4"	1"	1.74	2.22
217636A	** E-Z Rider	12	3/4	35	4"	1"	1.74	2.22
217633A	** E-Z Rider	10	3/4	40/41	4"	1"	1.74	2.22

\*COMET SELF CONTAINED

\*\*MAINTENANCE FREE-1 YEAR LIMITED WARRANTY

**SCS**  
**400**  
**SERIES**

## SINGLE SPROCKET SELF CONTAINED W/HEAVY DUTY NEEDLE BEARING

The 400 Series clutch is durable. Designed and built for direct drive mini-bikes, one of the most rugged applications ever required of a modestly-priced automatic centrifugal clutch. Having extra ability for rough service, 400 Series clutches are known to stand up better when the going gets rough. Sand, grit, gravel and dirt are taken in stride with the 400 Series clutch. Operates under conditions that would destroy most clutches.

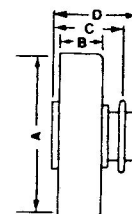

ORDER NO.	TYPE	TEETH	BORE	PITCH	A	B	C	D
206169A	SC*	12	1"	35	4"	1"	1.66	2.03
206170A	SC*	10	1"	40/41	4"	1"	1.72	2.03
216471A	SC*	13	3/4"	35	4"	1"	1.45	2.33
216472A	SC*	16	3/4"	219	4"	1"	1.45	2.33
216473A	SC*	11	3/4"	40/41	4"	1"	1.45	2.33

\*SELF CONTAINED

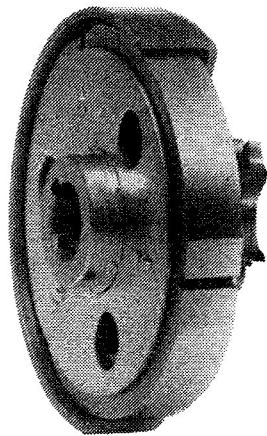

# LA 400 SERIES — AUTO CENTRIFUGAL CLUTCHES

## SINGLE SPROCKET

Use the 400 Series for 4 cycle engines only . . . to 8 H.P. "Straight centrifugal" rotor action provides slipping range into smooth, non-aggressive engagement with approximate engagement of 2,000 RPM's. Ideal for high-inertia applications such as mini-bikes, go-karts, etc. Ease of installation and maintenance makes the 400 Series clutch a favorite with thousands of mini-bikers and others who have tough service application requirements.

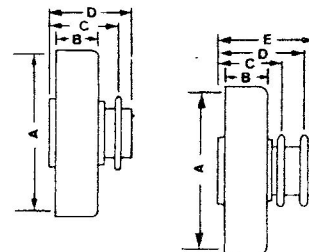

ORDER NO.	TYPE	TEETH	PITCH	BORE	KEYWAY	A	B	C	D
203963A	LA*	11	35	3/4	3/16	4"	1	1.73	2.04
203973A	LA*	12	40/41	3/4	3/16	4"	1"	1.80	2.04
203971A	LA*	11	40/41	3/4	3/16	4"	1"	1.80	2.04

\*LOOSE ASSEMBLY



# LA 350 SERIES — AUTO CENTRIFUGAL CLUTCHES

## SINGLE SPROCKET

Use the 350 Series for 4-cycle engines and electric motors to 6 H.P. and 2 cycle engines to 9 H.P. "Variable cam" rotor action adjustable for gradual or abrupt engagement. Excellent for industrial and utility applications plus go-karts, etc. Ease of installation and maintenance with fewer parts to be concerned about. Even the most inexperienced Saturday mechanic can install and/or maintain the 350 Series clutches.

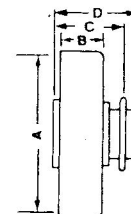

ORDER NO.	TYPE	TEETH	PITCH	BORE	KEYWAY	A	B	C	D
200224A	LA*	11	35	3/4	3/16	3-1/2	1"	1.65	1.97
11137A	LA*	12	40/41	3/4	3/16	3-1/2	1"	1.73	1.97
11135A	LA*	11	40/41	3/4	3/16	3-1/2	1"	1.73	1.97

\*LOOSE ASSEMBLY

### SPRING SELECTION (RPM)

Specially pre-stressed springs in various tensions are available. However, all 350 series clutches are standard equipped with 1800/2000 RPM springs. (approx. 100 revs. above high idle for most 4 cycle engines). Other than std. springs are available on factory assembled units in large quantities only.

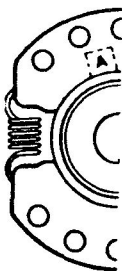

Alternate Springs Available For 350 Series Clutches					
PART NO.	COLOR	ENGAGEMENT R.P.M.	PART NO.	COLOR	ENGAGEMENT R.P.M.
200116A	White	1100/1300	200115A	Brown	2200/2400
*200114A	Red	1800/2000	200113A	Green	1300/1500
202297A	Blue	2300/2500	202299A	Black	3100/3300
*Spring #200114A standard in all 350 Series clutches.					

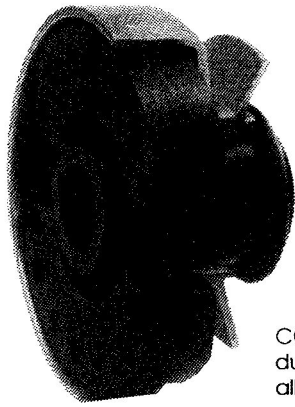

# SCP 350 SERIES — AUTO CENTRIFUGAL CLUTCHES

## SELF CONTAINED SINGLE PULLEY

COMET 350 Series Clutches are leaders of their class when it comes to durability. Their design and rugged construction is the reason. Ratings for all parts are much higher than will ever be required in normal service.

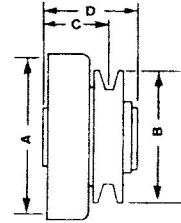

ORDER NO.	TYPE	KEYWAY OR KEY	BORE	A	B	C	D	BELT SECTION	PITCH DIA.	
									A	B
200181A	SCP*	3/16 K'WAY	5/8	3-1/2	3"	1.45	2.06	AB	2.63	3.09
200182A	SCP*	3/16 K'WAY	3/4	3-1/2	3"	1.45	2.06	AB	2.63	3.09
202313A	SCP*	5/32 K'WAY	7/8	3-1/2	3"	1.45	2.06	AB	2.63	3.09
202312A	SCP*	1/4 KEY	1"	3-1/2	3"	1.45	2.06	AB	2.63	3.09

\*SELF CONTAINED PULLEY

# SCDP 350 SERIES — AUTO CENTRIFUGAL CLUTCHES

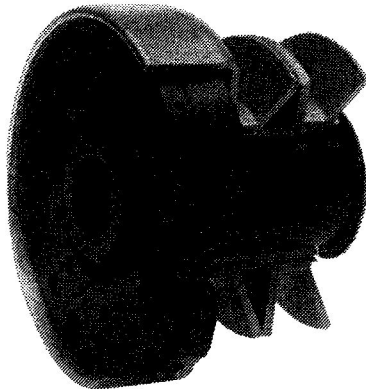

## SELF CONTAINED DOUBLE PULLEY

Solid steel pulleys . . . COMET double sheave models are the most rugged in the industry. Overload protection is one reason for using a centrifugal clutch. The 350 Series boasts the ideal characteristics for this feature, with either shoe setting or in any position. More flexibility of application. Many centrifugal clutches are limited in their application abilities . . . not the 350 Series. Anywhere it will fit, it will work.

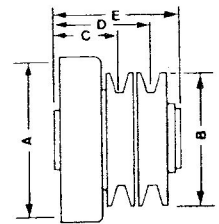

ORDER NO.	TYPE	KEYWAY OR KEY	BORE	A	B	C	D	E	BELT SECTION	PITCH DIA.	
										A	B
200269A	SCDP*	3/16 K'WAY	3/4	3-1/2	3"	1.48	2.23	2.90	AB	2.38	2.88
200271A	SCDP*	1/4 KEY	1"	3-1/2	3"	1.48	2.23	2.90	AB	2.38	2.88

\*SELF CONTAINED DOUBLE PULLEY

**Comet's 350 Series Clutches with ADJUSTABLE SHOE SETTINGS PROVIDE BETTER CONTROL OF ACCELERATION AND GREATER OVERLOAD PROTECTION — for moderate to fast starting requirements PLUS . . . . . they run cooler and last longer, with less maintenance required.**

### SELECTIVE ENGAGEMENT VIA VARIABLE SHOE SETTING

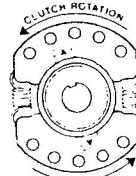

STANDARD ENGAGEMENT is smooth & gradual, up through the positive attitude. Has good overload protection. Ideal for average to high inertia starting. SHOE DRIVER LUGS MUST BE IN THE 11:00 O'CLOCK POSITION as shown in relation to clutch rotation. (All factory assembled clutches will have this setting, unless otherwise specified.)

FOR A MORE RAPID ENGAGEMENT — Remove the shoes from the Rotor Hub and reverse their positions to the 1:00 o'clock attitude in relation to clutch rotation as shown. This provides the clutch with a more rapid engagement contact. Overload protection remains good. This setting is ideal for low to average inertia starting. A desirable requirement in many applications.

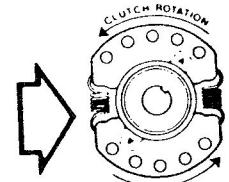

# INDUSTRIAL CLUTCHES

## CAST IRON PULLEY. STRAIGHT CENTRIFUGAL CLUTCH. FOR 4-CYCLE ENGINES TO 8 HP

SHOES: Long wearing, smooth engaging, organic material. Quiet.

BEARINGS: Double sealed roller type; precision ground and packed with  
hi-temperature grease

DRUM/PULLEY: One piece cast iron construction for rugged durability.

ENGAGEMENT SPEED: 1600 R.P.M.

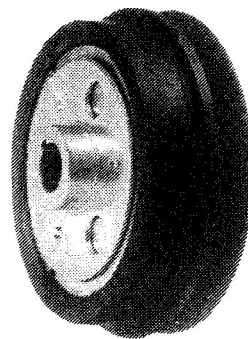

SCP-IC

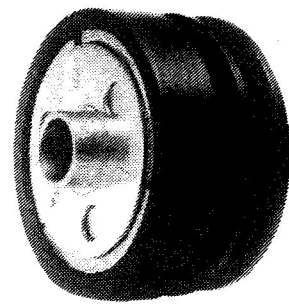

SCDP-IC

### SCP-IC\* — \*SELF CONTAINED SINGLE PULLEY INDUSTRIAL CLUTCH (FIG. 1)

ORDER NO.	TYPE	KEYWAY OR KEY	BORE	A	B	C	D	BELT SECTION	PITCH DIA.	
									A	B
212183A	SCP-IC*	3/16 K'WAY	3/4	4"	4.07	1.88	2.56	AB	3.54	4.00
211373A	SCP-IC*	3/16 KEY	7/8	4"	4.07	1.88	2.56	AB	3.54	4.00
212180A	SCP-IC*	1/4 KEY	1"	4"	4.07	1.88	2.56	AB	3.54	4.00
213176A	SCP-IC*	1/4 KEY	1"	4"	3.75	1.80	2.56	AB	3.23	3.69

### SCP-IC\* — \*SELF CONTAINED SINGLE PULLEY INDUSTRIAL CLUTCH (FIG. 2)

ORDER NO.	TYPE	KEYWAY OR KEY	BORE	A	B	C	D	BELT SECTION	PITCH DIA.	
									A	B
212177A	SCP-IC*	3/16 K'WAY	3/4	4"	5.37	1.80	2.56	AB	4.85	5.31
212178A	SCP-IC*	3/16 KEY	7/8	4"	5.37	1.80	2.56	AB	4.85	5.31
212179A	SCP-IC*	1/4 KEY	1"	4"	5.37	1.80	2.56	AB	4.85	5.31

### SCDP-IC\* — \*SELF CONTAINED DOUBLE PULLEY INDUSTRIAL CLUTCH (FIG. 3)

ORDER NO.	TYPE	KEYWAY OR KEY	BORE	A	B	C	D	E	BELT SECTION	PITCH DIA.	
										A	B
212190A	SCDP-IC*	3/16 K'WAY	3/4	4"	5"	1.91	2.66	3.13	AB	4.34	4.81
212184A	SCDP-IC*	1/4 KEY	1"	4"	5"	1.91	2.66	3.13	AB	4.34	4.81

FIG. 1  
SELF CONTAINED SINGLE PULLEY

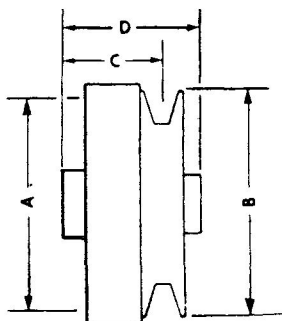

FIG. 2  
SELF CONTAINED SINGLE PULLEY

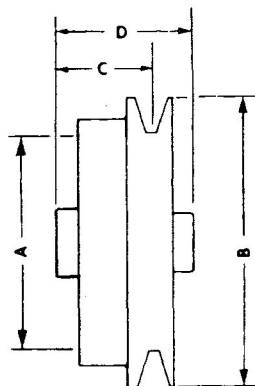
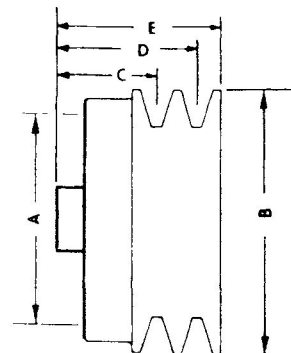

FIG. 3  
SELF CONTAINED DOUBLE PULLEY





# AUTOMATIC CENTRIFUGAL 3-1/2" SERIES CLUTCHES

## ASSEMBLIES — 200181A -200182A-202313A -202312A

ITEM NO.	ORDER NO.	DESCRIPTION	QTY. REQ.	INCLUDED IN ASSEMBLY #(S)
1	207900A	Single Pulley Drum & Sheave A-B Belt w/Bushing	1	(ALL MODELS)
2	200119A	Rotor Assembly, 5/8 I.D.	1	200181A
2	200121A	Rotor Assembly, 3/4 I.D.	1	200182A
2	200123A	Rotor Assembly, 7/8 I.D.	1	202313A
2	200125A	Rotor Assembly, 1" I.D.	1	202312A
3	200114A	** Spring, Red	2	(ALL MODELS)
4	200764A	Screw, Set, Socket Hd. Nyloc, Cup Point, 1/4-28 x 5/16	2	200181A-200182A-202313A
4	200763A	Screw, Set, Socket Hd. Nyloc, Cup Point, 1/4-28 x 1/4	2	202312A
5	204495A	Clutch Shoe	2	(ALL MODELS)
6	200147A	Washer, Thrust Fiber, 1-3/8" I.D. x 1/32	2	(ALL MODELS)
7	200268A	Spacer, Steel, 1.373 I.D. x 5/6 W.D.	1	(ALL MODELS)
8	1003A	Ring, Snap (Tru-Arc RST-137) 1-3/8"	1	(ALL MODELS)

\*LISTED BELOW ARE ACCESSORY PARTS AVAILABLE FROM YOUR COMET DEALER.

9	202715A	Steel Collar w/Set Screw, 7/8 I.D., 9/16 x 1-1/2 O.D.	1	202313A
9	202716A	Steel Collar w/Set Screw, 1" I.D. x 5/8 O.D.	1	202312A
9	11199A	Steel Collar w/Set Screw, 5/8 I.D.	1	200181A
9	11217A	Steel Collar w/Set Screw, 3/4 I.D.	1	200182A
10	202473A	Key, 5/32 x 5/32 x 1-1/2" Long for 7/8 I.D.	1	202313A
10	203604A	Key, 3/16 x 3/16 x 1-1/2" Long for 5/8 and 3/4 I.D.	1	200181A - 200182A

\*\*Spring #200114A standard in all 350 Series Clutches.

## SCP 350 SERIES SINGLE PULLEY

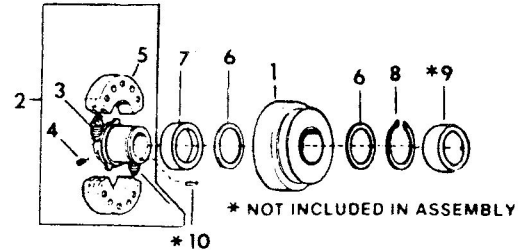

## ASSEMBLIES — 200269A-200271A

ITEM NO.	ORDER NO.	DESCRIPTION	QTY. REQ.	INCLUDED IN ASSEMBLY #(S)
1	200265A	Double Pulley Drum & Sheave A-B Belt w/Bushing	1	(ALL MODELS)
2	200259A	Rotor Assembly, 3/4" I.D.	1	200269A
2	200263A	Rotor Assembly, 1" I.D. with 1/4 Key	1	200271A
3	200114A	** Spring, Red	2	(ALL MODELS)
4	204495A	Clutch Shoe	2	(ALL MODELS)
5	200147A	Washer, Thrust Fiber 1-3/8" I.D.	2	(ALL MODELS)
6	200268A	Spacer, Steel	1	(ALL MODELS)
7	1003A	Snap Ring (Tru-Arc RST-137) 1-3/8"	1	(ALL MODELS)

\*LISTED BELOW ARE ACCESSORY PARTS AVAILABLE FROM YOUR COMET DEALER.

8	202717A	Washer, Steel, 3/8 I.D. x 1-1/2 O.D.	1	(ALL MODELS)
9	202718A	Screw, Hex Hd. Cap, 3/8-24 x 1"	1	(ALL MODELS)
10	200490A	Key, 3/16 x 3/16 x 2" for 3/4 I.D.	1	200269A
10	203605A	Key, 5/32 x 5/32 x 2" for 7/8 I.D.	1	200271A

\*\*Spring #200114A standard in all 350 Series Clutches.

## SCDP 350 SERIES DOUBLE PULLEY

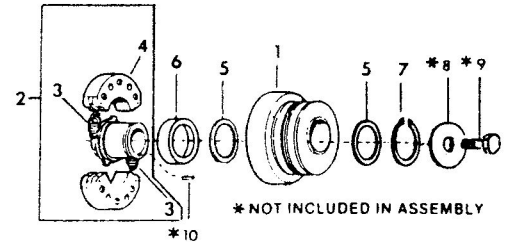

## ASSEMBLIES — 200224A-11135A-11136A-11137A-11132A-11134A \*OBSOLETE

ITEM NO.	ORDER NO.	DESCRIPTION	QTY. REQ.	INCLUDED IN ASSEMBLY #(S)
1	11128A	Drum/Sprocket Assembly, 10 Tooth, #40/41 Chain, 3-3/4 Dia.	1	11132A
1	11129A	Drum/Sprocket Assembly, 11 Tooth, #40/41 Chain, 3-3/4 Dia.	1	11134A-11135A
1	11130A	Drum/Sprocket Assembly, 12 Tooth, #40/41 Chain, 3-3/4 Dia.	1	11136A-11137A
1	200220A	Drum/Sprocket Assembly, 11 Tooth, #35 Chain, 3-3/4 Dia.	1	200224A
2	200239A	Rotor Assembly, 5/8 I.D. w/3/16 Keyway x 3-1/2 Dia.	1	11132A-11134A-11136A
2	200240A	Rotor Assembly, 3/4 I.D. w/3/16 Keyway x 3-1/2 Dia.	1	200224A-11135A-11137A
3	200114A	** Spring, For 1800-2000 RPM Engagement, Red	2	(ALL MODELS)
4	204495A	Clutch Shoe	2	(ALL MODELS)
5	200756A	Screw, Set, Socket Head, Nyloc Cup Point Type, 1/4-28 x 3/8 Long	2	(ALL MODELS)
6	200680A	Washer, Fiber, 5/8 I.D. x 1-3/32 O.D. x 1/32 Thick	1	11132A-11134A-11136A
6	200681A	Washer, Fiber, 3/4 I.D. x 1-3/32 O.D. x 1/32 Thick	1	200224A-11135A-11137A
7	200834A	Washer, Steel, 5/8 I.D. x 1-1/16 O.D. x 1/16 Thick	1	11132A-11134A-11136A
7	200836A	Washer, Steel, 3/4 I.D. x 1-1/16 O.D. x 1/16 Thick	1	200224A-11135A-11137A
8	11067A	Bushing, Bronze, Oilite, 3/4 I.D. w/Partial 3/16 Key x 7/8 O.D. x 7/8 Long	1	200224A
8	200199A	Bushing, Bronze, Oilite, 5/8 I.D. w/Partial 3/16 Key x 15/16 O.D. x 7/8 Long	1	11132A-11134A-11136A
8	200200A	Bushing, Bronze, Oilite, 3/4 I.D. w/Partial 3/16 Key x 15/16 O.D. x 7/8 Long	1	11135A-11137A

\*LISTED BELOW ARE ACCESSORY PARTS AVAILABLE FROM YOUR COMET DEALER

9	11199A	Retaining Collar, Steel w/Nyloc Set Screw, 5/8 I.D. (Helps Retain Clutch On Crank)	1	11132A-11134A-11136A
9	11217A	Retaining Collar, Steel w/Nyloc Set Screw, 3/4 I.D. (Helps Retain Clutch On Crank)	1	200224A-11137A-11135A
10	200486A	Key, Steel, 3/16 x 3/16 x 3/4 Long	1	(ALL MODELS)

\*\*Spring #200114A standard in all 350 Series Clutches.

## LA 350 SERIES LOOSE ASSEMBLY

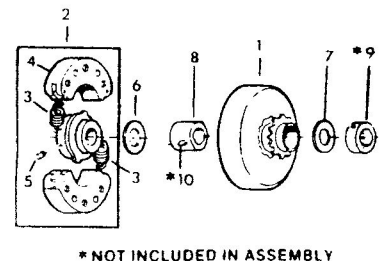



358 N.W. F Street Richmond, IN 47374-2297 (765) 966-8161 Fax: (765) 935-2346  
http://www.hoffcocomet.com

**WE RECOMMEND THE MOUNTING OF ALL CLUTCHES WITH BOLT AND LOCK WASHER TO END OF CRANKSHAFT.**

**NOTE: ROTOR SETTINGS, SPRINGS & ENGAGEMENT INFORMATION APPLICABLE TO ALL MODELS OF THE S350 SERIES CLUTCHES.**

## WHEN SELECTING A GO-KART OR MINI-BIKE CLUTCH . . .

There are many variations to consider. However . . . one thing is certain . . . *THE ENGINE CLUTCH ON A GO-KART OR MINI-BIKE IS ONE OF THE TOUGHEST APPLICATIONS EVER REQUIRED OF A MODESTLY PRICED CENTRIFUGAL CLUTCH, AND . . . if the bike is DIRECT DRIVE, the engine clutch must absorb a considerably larger shock load than others (jackshaft arrangements.)* This is especially true where the bike rider is "popping wheelies", patching out . . . and what about the beginning rider who holds the brake on and rides very slow, allowing the clutch to engage & disengage repeatedly. This is extremely rough on the clutch. The situation can be compounded if the sprocket ratio is not compatible. Care should always be exercised when selecting a go-kart or mini-bike clutch. *THE PROPER SPROCKET RATIOS ARE JUST AS IMPORTANT AS THE CORRECT OPERATION OF THE CLUTCH. ENGAGEMENT SHOULD ALWAYS BE ACHIEVED BY A SMOOTH ADVANCEMENT OF THE THROTTLE . . . AND NEVER AN ERRATIC MOVEMENT. FOR SELECTING A GOOD CLUTCH TO REAR WHEEL RATIO ARRANGEMENT . . . USE THE FOLLOWING SUGGESTIONS.*

Engine	Crankshaft Dia.	No. Of Teeth On Engine Clutch Sprocket	No. Of Teeth On Rear Wheel Sprocket
3 1/4 H.P.	5/8" dia.	10	60
4-5 H.P.	3/4" dia.	11	60
4-5 H.P.	3/4" dia.	12	72

**NOTE: NO LESS THAN A 72 TOOTH REAR WHEEL SPROCKET SHOULD EVER BE USED ON A DIRECT DRIVE GO-KART OR MINI-BIKE WHEN THE ENGINE HAS A 12 TOOTH SPROCKET.**

### ALTERNATE SPRINGS AVAILABLE For 350 Series Clutches

Part No.	Color	Engagement R.P.M.	Part No.	Color	Engagement R.P.M.
200116A	White	1100/1300	200115A	Brown	2200/2400
200113A	Green	1300/1500	202297A	Blue	2300/2500
** 200114A	Red	1800/2000	202299A	Black	3100/3300

**\*\* Spring #200114A standard in all 350 Series Clutches**

## LA 350 SERIES

### "LOOSE ASSEMBLY" CLUTCH

#### WHEN INSTALLING YOUR NEW LA 350 SERIES "LOOSE ASSEMBLY" CENTRIFUGAL CLUTCH:

1. Do the number of teeth in your new clutch give you the right drive ratio for your machine's horsepower and weight?
2. Always make sure the set screws in clutch rotor hub are tightened securely before starting engine the first time.
3. WE RECOMMEND THE MOUNTING OF ALL CLUTCHES WITH BOLT AND LOCK WASHER TO END OF CRANKSHAFT. However, if preferred, clutch retaining collar may be used. Always check for loosened mounting bolts, set screws, etc.
4. As added security for clutch's retention on shaft, it is advisable to mount this clutch with bolt and lock washer to end of crankshaft. Many crankshafts are already drilled and tapped.
5. Parallel, true alignment of clutch sprocket with secondary drive sprocket is all-important to prevent excessive wear and jumping of chain. Please install clutch accordingly.
6. **CAUTION!** Never start engine without adequate clutch & chain guard in place.

#### SERVICING/PROLONGING THE LIFE OF YOUR "LOOSE-ASSEMBLY" CLUTCH:

1. Don't operate your clutch with a "banjo string-tight" chain. Allow slight slack . . . equivalent to perhaps half of a link.
2. Occasionally add a few drops of light oil to both chain and sprockets and bronze bushing/needle bearing. Never oil the clutch shoes or excessive slippage and wear will result.
3. Regularly check for loosened mounting set screws, etc. and re-tighten. This is extremely important!
4. Always replace S350 Series shoes and springs as new sets to avoid mis-matched sets and unbalanced clutch operation.
5. When replacing oilite bronze bushing always use care to install it with the "keyed" end toward outer end of crankshaft.

### SELECTIVE ENGAGEMENT VIA VARIABLE SHOE SETTING

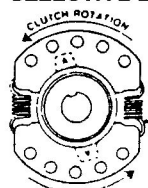

STANDARD ENGAGEMENT is smooth & gradual, up through the positive attitude. Has good over-load protection. Ideal for average to high inertia starting. SHOE DRIVER LUGS MUST BE IN THE 11:00 O'CLOCK POSITION as shown in relation to clutch rotation. (All factory assembled clutches will have this setting, unless otherwise specified.)

FOR A MORE RAPID ENGAGEMENT — Remove the shoes from the Rotor Hub and reverse their positions to the 1:00 o'clock attitude in relation to clutch rotation as shown. This provides the clutch with a more rapid engagement contact. Over-load protection remains good. This setting is ideal for low to average inertia starting. A desirable requirement in many applications.

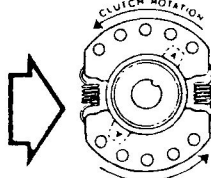

### Did You Know . . . ?

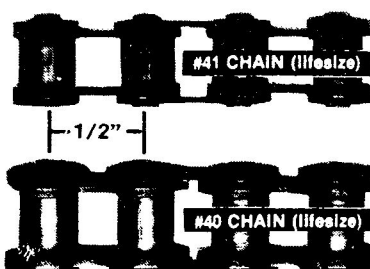

### Did You Know . . . ?

**Ratio in your drive train . . .** is a vital concept to you as it greatly affects your machine's load-carrying ability and its speed. Too high a ratio causes minimal "pulling power" (it's like starting a truck out in 3rd gear) and excessive speed potential . . . while too low a ratio causes just the opposite effects! When using an automatic centrifugal clutch in any but a racing application, as a rule it is wisest to use the clutch with fewest teeth or smallest pulley diameter. This gives most machines a good "power versus speed" compromise. Likewise, clutches tend toward even greater efficiency and more "pulling power" when the machine's final drive sprocket or pulley is also altered to a larger diameter.





358 NW F Street Richmond, IN 47374-2297  
(765) 966-8161 Fax: (765) 935-2346  
<http://www.hoffcocomet.com>

# AUTOMATIC CENTRIFUGAL 4" SERIES CLUTCHES

## ASSEMBLIES

206169A-206170A  
216471A-216472A-216473A

NOTE: THESE MODELS MUST BE  
RETAINED ON ENGINE CRANK-  
SHAFT WITH LOCK WASHER, FLAT  
WASHER AND BOLT.

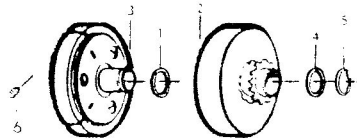

## SC 400 SERIES SELF CONTAINED

### INCLUDED IN

ITEM #	ORDER #	DESCRIPTION	QTY. REQ.	ASSEMBLY #(S)
1	200681A	Washer, Fiber-Phenolic, 3/4" I.D. x 1-3/32 O.D. x 1/32 Thick	1	206169A-106170A
1	216470A	Washer, Steel, 7/8" I.D. x 1-7/16 O.D. x 1/32 Thick	1	216971A-216472A-216473A
2	205329A	Drum/Sprocket Assembly w/Bearing #205279A, 12 Tooth, #35 Chain, 7/8 I.D. x 4 1/4" Dia.	1	206169A
2	205331A	Drum/Sprocket Assembly w/Bearing #205279A, 10 Tooth, #40/41 Chain, 3/4 I.D. x 4 1/4" Dia.	1	206170A
2	216469A	Drum/Sprocket Assembly w/Needle Bearing, 13T, #35 P Sprocket	1	216471A
2	216466A	Drum/Sprocket Assembly w/Needle Bearing, 16T, #219P Sprocket	1	216472A
2	216476A	Drum/Sprocket Assembly w/Needle Bearing, 11T, #40/41P Sprocket	1	216473A
3	206172A	Rotor Assembly, 1" Dia. w/1/4" Key x 4" Dia. w/7/8" Long Retainer Extension	1	206169A-106170A
3	216461A	Rotor Assembly, 3/4" w/3/16" Key	1	216471A-216472A-216473A
4	205288A	Washer, Steel, 3/4" I.D. x 1-1/16" O.D. x 1/32" Thick	1	206169A-206170A
4	216470A	Washer, Steel, 7/8 I.D. x 1-7/16" O.D. x 1/32 Thick	1	216471A-216472A-216473A
5	204924A	Retaining Ring, Snap, External, 1" Bore Rotor Assembly	1	206169A-206170A
5	204925A	Retaining Ring, 3/4" Bore	1	216471A-216472A-216473A
6	200763A	Set Screw, 1/4-28 x 1/4" Nyloc	1	216471A-216472A-216473A

## ASSEMBLIES

209748A-209760A  
209768A-211627A

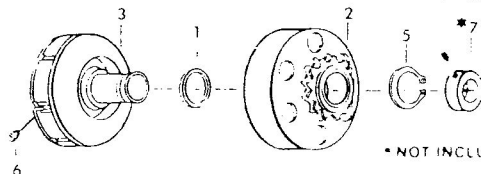

## CSC 400 SERIES SELF CONTAINED

ITEM #	ORDER #	DESCRIPTION	QTY. REQ.	INCLUDED IN ASSEMBLY #(S)
1	200681A	Washer, Fiber 3/4 I.D. x 1-3/32 Thick	1	209748A-211627A
1	204872A	Washer, Fiber 7/8 I.D. x 1-1/8 O.D. x 1/32 Thick	1	209760A-209768A
2	209749A	Drum and Sprocket w/Bushing #209787A and Retaining Ring, 11 Tooth, #35 Chain	1	209748A
2	209761A	Drum and Sprocket w/Bushing #209753A and Retaining Ring, 12 Tooth, #35 Chain	1	209760A
2	209769A	Drum and Sprocket w/Bushing #209753A and Retaining Ring, 10 Tooth, #40/41 Chain	1	209768A
2	211648A	Drum and Sprocket w/Bushing #211649A and Retaining Ring, 12 Tooth, #35 Chain	1	211627A
3	209762A	Rotor Assembly	1	209768A-209760A
3	209750A	Rotor Assembly	1	209748A-211627A
5	204924A	Retaining Ring, Snap, External 5/8	1	209748A-211627A
5	204925A	Retaining Ring, Snap, External 3/4	1	209768A-209760A
6	200763A	Set Screw, Soc. Hd. 1/4-28 x 1/4 Long	1	(ALL MODELS)

### \*LISTED BELOW ARE ACCESSORY PARTS AVAILABLE FROM YOUR COMET DEALER

7	11199A	Retaining Collar, Steel w/Nyloc Set Screw, 5/8 I.D. (Helps Retain Clutch On Crank)	1	209748A-211627A
7	11217A	Retaining Collar, Steel w/Nyloc Set Screw, 3/4 I.D. (Helps Retain Clutch On Crank)	1	209768A-209760A

## ASSEMBLIES

203963A-203968A\*-203970A\*  
203971A-203972A\*  
203973A-2039775\*

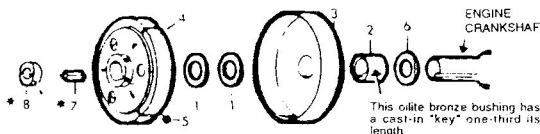

## LA 400 SERIES LOOSE ASSEMBLY

ITEM #	ORDER #	DESCRIPTION	QTY. REQ.	INCLUDED IN ASSEMBLY #(S)
1	200680A	Washer, Fiber, 5/8 I.D. x 1-3/32 O.D. x 1/32 Thick	2	203968A-203970A-203972A
1	200681A	Washer, Fiber, 3/4 I.D. x 1-3/32 O.D. x 1/32 Thick	2	203963A-203971A-203973A-203975A
2	11067A	Bushing, Bronze-Oilite, 3/4 I.D. w/Partial 3/16 Key x 7/8 O.D. x 7/8 Long	1	203963A
2	200199A	Bushing, Bronze-Oilite, 5/8 I.D. w/Partial 3/16 Key x 15/16 O.D. x 7/8 Long	1	203968A-203970A-203972A
2	200200A	Bushing, Bronze-Oilite, 3/4 I.D. w/Partial 3/16 Key x 15/16 O.D. x 7/8 Long	1	203971A-203973A
2	200202A	Bushing, Bronze-Oilite, 3/4 I.D. w/Partial 3/16 Key x 15/16 O.D. x 1-1/8 Long	1	203975A
3	11168A	Drum/Sprocket Assembly, 10 Tooth, #40/41 Chain, 4-1/4 Dia.	1	203968A
3	11169A	Drum/Sprocket Assembly, 11 Tooth, #40/41 Chain, 4-1/4 Dia.	1	203970A-203971A
3	11170A	Drum/Sprocket Assembly, 12 Tooth, #40/41 Chain, 4-1/4 Dia.	1	203972A-203973A
3	200037A	Drum/Twin Sprocket Assembly, 12 Tooth, #35 Chain, 4-1/4 Dia.	1	203974A-203975A
3	200226A	Drum/Sprocket Assembly, 11 Tooth, #35 Chain, 4-1/4 Dia.	1	203962A-203963A
4	204052A	Rotor Assembly, 5/8 I.D. w/3/16 Keyway x 4" Dia. w/Iron Shoes	1	203968A-203970A-203972A
4	204053A	Rotor Assembly, 3/4 I.D. w/3/16 Keyway x 4" Dia. w/Iron Shoes	1	203963A-203973A-203971A-203975A
5	200763A	Set Screw, Socket Head Nyloc Cup Point Type, 1/4-28 x 1/4 Long, Rotor Assembly	2	203963A-203971A-203973A-203975A
5	200764A	Set Screw, Socket Head Nyloc Cup Point Type, 1/4-28 x 5/16 Long, Rotor Assembly	2	203968A-203970A-203972A
6	200834A	Washer, Steel, 5/8 I.D. x 1-3/32 O.D. x 1/16 Thick	1	203968A-203970A-203972A
6	200836A	Washer, Steel, 3/4 I.D. x 1-3/32 O.D. x 1/16 Thick	1	203963A-203973A-203971A-203975A

### \*LISTED BELOW ARE ACCESSORY PARTS AVAILABLE FROM YOUR COMET DEALER

7	200486A	Key, Steel, 3/16 x 3/16 x 3/4 Long	1	(ALL MODELS)
8	11199A	Retaining Collar, Steel w/Nyloc Set Screw, 5/8 I.D. (Helps Retain Clutch On Crank)	1	203968A-203970A-203972A
8	11217A	Retaining Collar, Steel w/Nyloc Set Screw, 3/4 I.D. (Helps Retain Clutch On Crank)	1	203963A-203973A-203971A-203975A

161170A 0803 PRINTED U.S.A.

***COMET***  
**INDUSTRIES**  
**NEW INDUSTRIAL CLUTCH**

**SPECIFICATIONS**

**PART NUMBER 218215A**

**SIZE** --FOUR (4) INCH DIAMETER BY 2 7/8" THRU THE BORE

**ACTUATION** -- 4 SHOES

**CALIBRATION** -- SPRING

**SPRING TYPE** -- GARTER

**HOUSING** -- CAST IRON

**FINISH** -- PLATED

**DRIVE** -- SINGLE PULLEY

**BORE** -- ONE (1) INCH

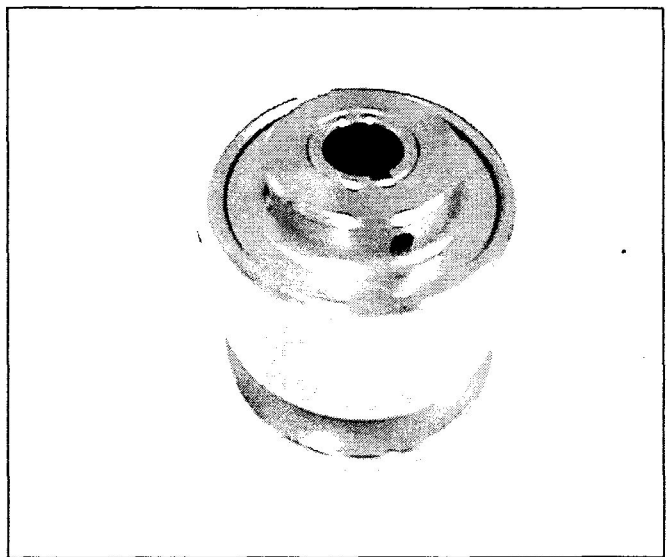

**HORSEPOWER** -- 4 CYCLE TO 15 H.P.

**ENGAGEMENT SPEED** -- 1700 RPM

**BELT SELECTION** -- A OR B

**USED ON** -- Band saws -- Pumps -- Air compressors -- Compactors -- Sprayers -- Small chippers  
Cement finishing equipment -- Industrial equipment

**COMET® INDUSTRIES**  
**358 N.W. F ST.**  
**RICHMOND, INDIANA 47374**  
**PHONE -- 765-966-8161**  
**FAX -- 765-935-2346**