



MODULAR WORM-GEAR REDUCTION BOX

200 SERIES CENTRIFUGAL CLUTCH

APPLICATIONS

Agricultural

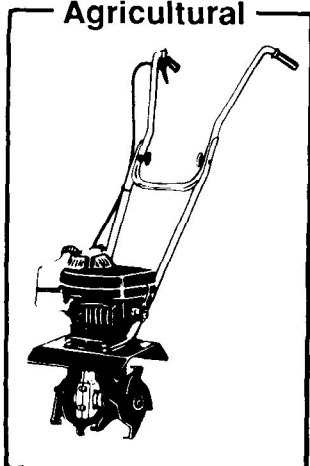

Recreational

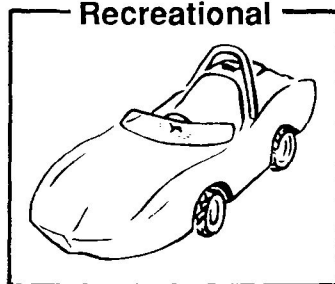

Industrial

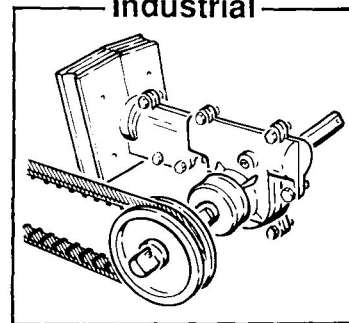

FEATURES - MODULAR WORM GEAR REDUCTION BOX

- 32:1 Reduction ratio
- Needle thrust pack
- Grease fill check plug
- Direct mounting to Tecumseh TC200 Engine
- Mating 2-1/8" Dia. centrifugal clutch rotor available.

FEATURES - 200 SERIES CENTRIFUGAL CLUTCH

The Comet 200 SERIES CLUTCH is the perfect clutch for 1/2 to 2-1/2 H.P. engines such as Tecumseh 200 and 300 Series. Also perfect for other applications requiring small centrifugal clutches.

COMET INDUSTRIES

358 N.W. "F" Street, Richmond, 47374-2297
TEL: (765) 966-8161 FAX: (765) 935-2346
<http://www.hoffcocomet.com>

DIMENSIONAL DRAWING



MODULAR WORM-GEAR REDUCTION BOX DISPLACEMENT LAYOUT DIMENSIONS

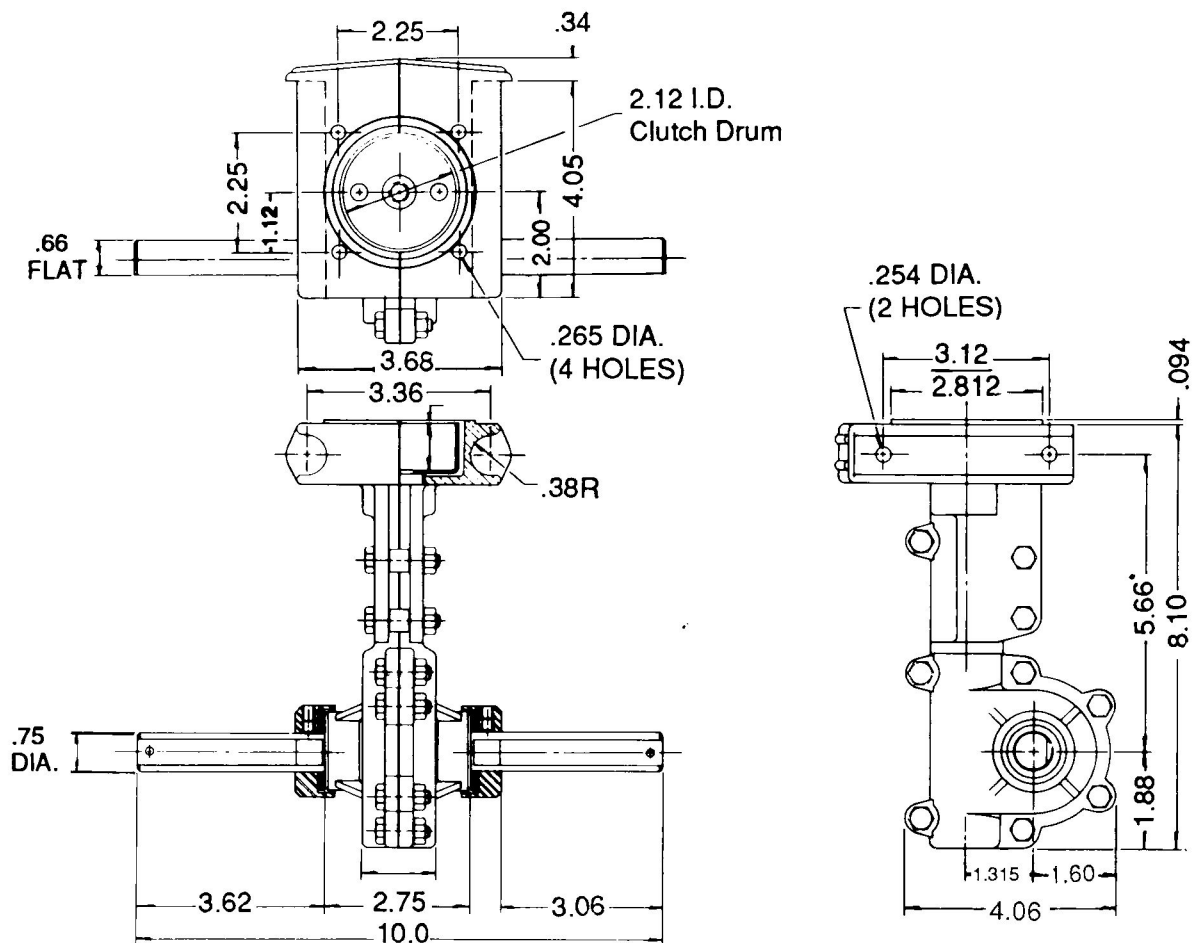

NOTE: Dimensions and ratios are in accordance with engineering drawings, current with the date shown on this item. Specifications are subject to change without notice.

200 SERIES CENTRIFUGAL CLUTCH 213774C

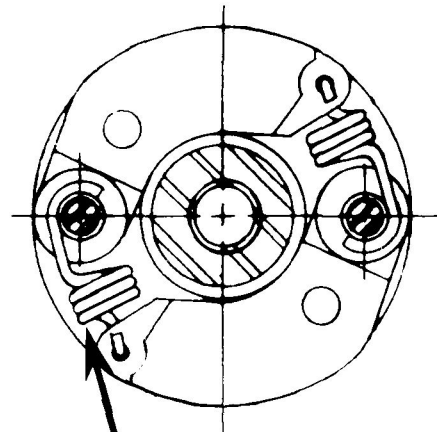
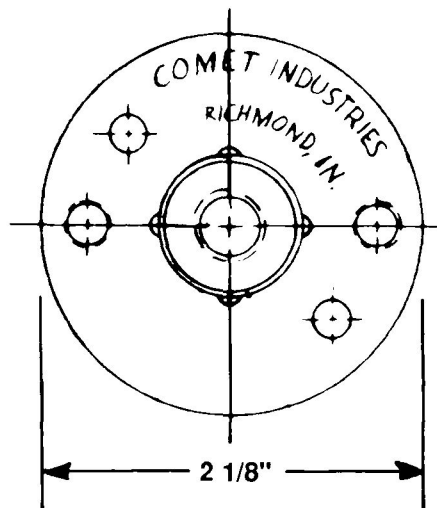

SPRING - 213773C

3200 R.P.M. AVAILABLE. Other engagements available on a quote basis to your specifications.

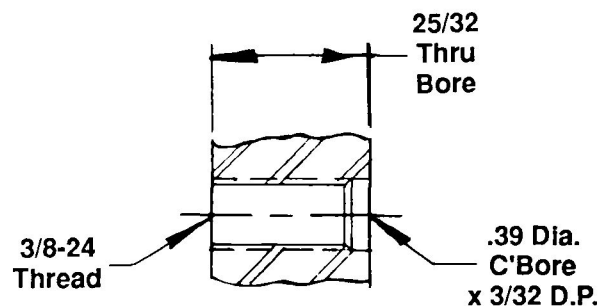
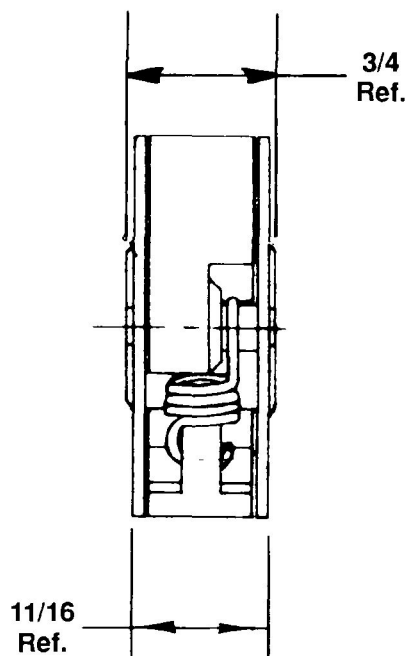

3/8-24 BORE AVAILABLE. Other bores available on a quote basis to your specifications.

SPECIFICATIONS

WORM GEAR REDUCTION BOX

HOUSINGS: High-strength, lightweight aluminum die cast.

SHAFTING: High carbon steel.

GEARING: Cold formed steel worm w/manganese bronze wheel.

BEARINGS: Double sealed ball and powder bronze.

SEALS: Rubber coated lip and dust cup w/integral felt seal

SPECIFICATIONS

200 SERIES CLUTCH

TYPE: 2-1/8" Diameter, Flail Action

ROTOR WIDTH: .780.

SHOES: Sintered Iron

SHOE WIDTH: .560 - may be installed in "Aggressive" or "Non-aggressive" position.

AVAILABLE ENGAGEMENT: 3200 R.P.M.

AVAILABLE BORE: 3/8-24 R.H. Thread

Other bores and/or engagements available on an OEM basis.

DRUMS: Sprockets, Couplings, Pulleys, Arbors available to your specifications.